

Wi-Fi Thermostats SmartLife Connection

Thank you for purchasing one of our products and for your support.

1

Download the Smart Life app from the IOS or Android Store. And create a unique account and password.

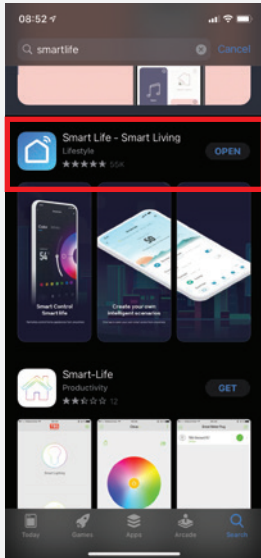

2

In the home screen of smart life. Press on the area highlighted to add a thermostat to the App.

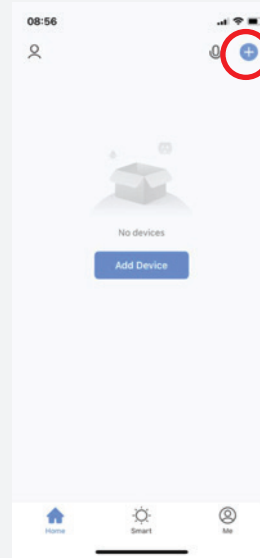

3

On the next screen please select small home appliances and then search the list until you reach thermostat (Wi-Fi).

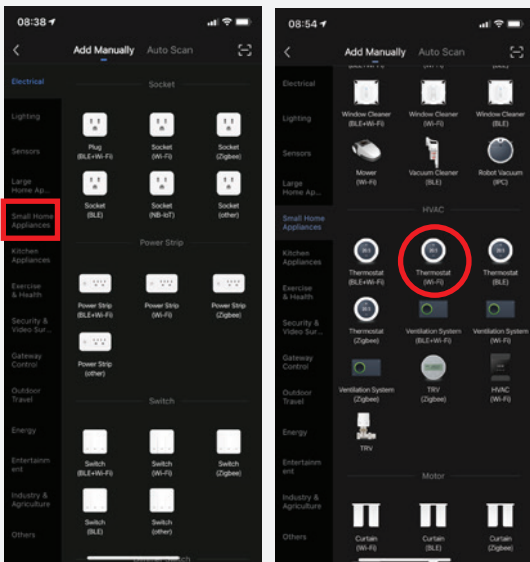

4

Select your Wi-Fi network and enter the Password for your router at home.

Press Next.

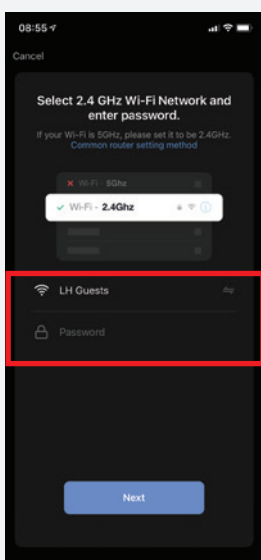

5

To get the thermostat ready to pair to device/app, press the wi-fi symbol at the top of screen (highlighted below)

on the next screen, select hand symbol (not AP mode). The thermostat is now ready to pair to Smart Life in ez mode.

ez mode should also be shown on top right of app screen (if not please select on the dragdown option).

press next at bottom of screen on the app.

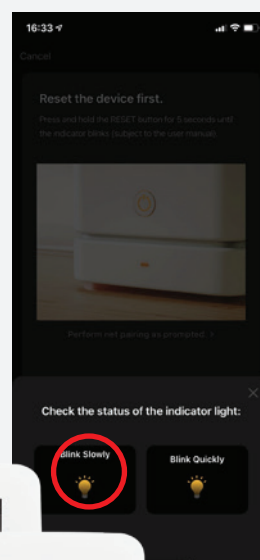

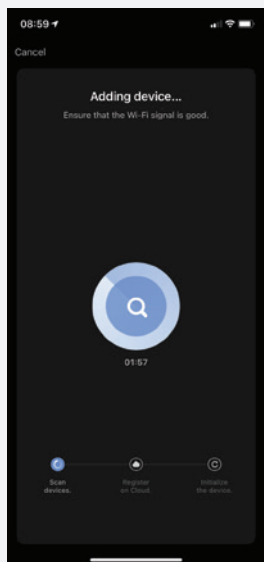

6

The thermostat should now pair to the device.

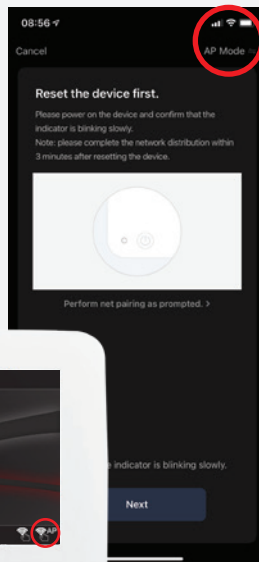

7

If the thermostat fails to connect to the thermostat then repeat steps 2,3 and 4.

hold down the Set and OK button until the cloud symbol only appears on the thermostat screen.

on the top right corner of the app select app mode on the screen and press tick box at bottom left of screen.

press next

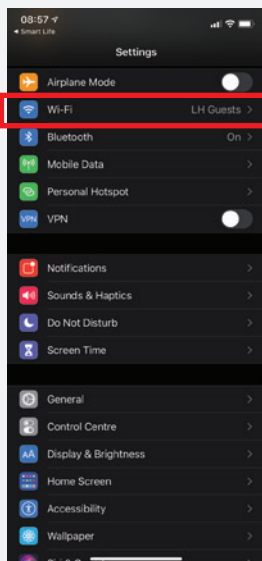
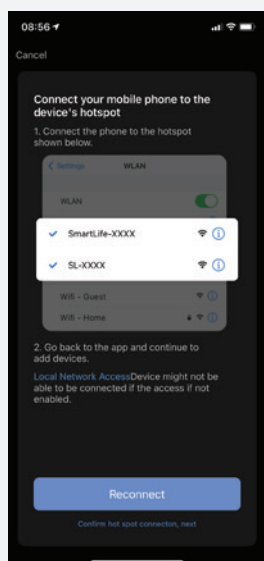

8

On the next screen. Press go to connect. This should take you directly Into your phone settings (See Below).

If not then exit app (Don't Close) and go into settings as shown on below (Middle Screenshot).

Then select Smart Life in 'my Networks' or 'wi Fi Network'

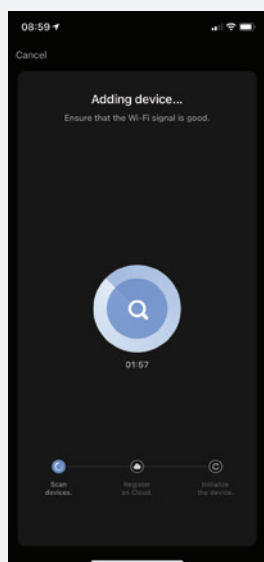
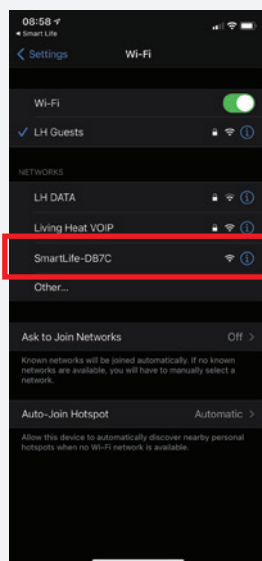

9

You should then be directed back to the app. If not go back into the app and the countdown screen should appear.

The thermostat should now pair to the device.

ANDROID APP



IOS APP

